



## 5-Gallon Lawn Sprayer

TL50

### Owner's Manual and Operating Instructions

*Original Instructions*



California Proposition 65

#### **⚠ WARNING**

This product can expose you to chemicals, including lead, which are known to the State of California to cause cancer and birth defects or other reproductive harm.

#### **⚠ CAUTION**

Read this document before operating or servicing the sprayer.



## TABLE OF CONTENTS

---

PREFACE.....	4
SAFETY .....	5
OPERATING INSTRUCTIONS.....	9
AFTER SPRAYING CLEAN-OUT / MAINTENANCE / STORAGE .....	10
TROUBLESHOOTING.....	11

## PREFACE

---

This manual has been prepared to acquaint you with the safety information, operation, and maintenance of your new sprayer. Improper operation could cause personal injury and/or equipment and property damage. Read and understand this Owner's Manual before operating or making adjustments. Keep this manual accessible.

Your authorized dealer is the best source of replacement parts & service. To obtain prompt, efficient service, remember to give the following information:

- Correct part description and part number.
- Model number of your sprayer.

Part description and part numbers can be obtained from the illustrated Parts List. For warranty work always take your original sales slip, or other evidence of purchase date, to your distributor/dealer.

### WARRANTY REGISTRATION

Warranty registration is available online at [www.TurfExproducts.com](http://www.TurfExproducts.com). Under "Support" click "Warranty Registration" and submit the form online.

### OWNER'S INFORMATION

Owner's Name: \_\_\_\_\_

Date Purchased: \_\_\_\_\_

Sales Outlet Name: \_\_\_\_\_ Phone: \_\_\_\_\_

Sales Outlet Address: \_\_\_\_\_

Sprayer Type (Model): \_\_\_\_\_

Production date (stamped on last page of this manual): \_\_\_\_\_

# SAFETY

## SAFETY DEFINITIONS

### **WARNING**

Indicates a potentially hazardous situation that, if not avoided, could result in death or serious personal injury.

### **CAUTION**

Indicates a potentially hazardous situation that, if not avoided, may result in minor or moderate injury. It may also be used to alert against unsafe practices.

**NOTE:** Indicates a situation or action that can lead to damage to your sprayer and vehicle or other property. Other useful information can also be described.

## SAFETY PRECAUTIONS

Improper operation could cause personal injury and/or equipment and property damage. Read and understand labels and the Owner's Manual before operating or making adjustments.

### **WARNING**

- Always make sure personnel are clear of areas of danger when using equipment.
- Before working with the sprayer, secure all loose-fitting clothing and unrestrained hair.
- Always wear safety glasses with side shields when servicing sprayer. Failure to do this could result in serious injury to the eyes.
- Do not climb onto or ride on sprayer.

## FUSES

If a problem should occur and fuse replacement is necessary, the replacement fuse must be of the same type and amperage rating as the original. Installing a fuse with a higher rating can damage the system and could start a fire. Fuse Replacement, including fuse ratings and locations, is located in the Maintenance section of this Owner's Manual.

## PERSONAL SAFETY

- Wear only snug-fitting clothing while working on your sprayer system.
- Wear protective clothing, eye protection, and chemical-resistant gloves when filling, using, and cleaning the sprayer. Wear additional protective gear, such as face mask or apron, as recommended on the chemical label.
- Do not wear jewelry or a necktie, and secure long hair.
- Wear safety goggles to protect your eyes from brine, battery acid, gasoline, dirt, and dust.
- Do not eat, drink, smoke, rub your eyes, or touch bare skin while spraying.
- Always have a fire extinguisher rated BC handy, for flammable liquids and electrical fires.
- Never point spray wand at people or animals.

## BATTERY SAFETY

### **CAUTION**

Batteries normally produce explosive gases which can cause personal injury. Therefore, do not allow flames, sparks, or lit tobacco to come near the battery. When charging or working near a battery, always cover your face and protect your eyes, and also provide ventilation.

- Disconnect the battery before removing or replacing any electrical components.

# SAFETY

## CHEMICAL SAFETY



### ⚠ CAUTION

Read and adhere to manufacturer's material package labeling, including Safety Data Sheet requirements.

Immediate response is necessary in the event of sprayer leaks, bodily chemical contact, poisoning, or spills. See instructions below.

<b>Sprayer Leak</b>	If the sprayer develops a leak, immediately stop spraying. Turn OFF power to the sprayer and follow directions below, as applicable.
<b>Bodily Chemical Contact</b>	<p>Personal contamination can occur when chemicals splash, spill, or spray directly onto a person.</p> <ol style="list-style-type: none"><li>1. Immediately follow First Aid instructions on chemical label. <u>General procedures include:</u><ol style="list-style-type: none"><li>1a. Eyes – immediately flush with water.</li><li>1b. Skin – wash all contaminated skin surfaces with soap and water.</li><li>1c. Clothing – remove contaminated clothing. Dispose of heavily contaminated clothing per chemical label instructions.</li></ol></li><li>2. Seek medical advice if instructed on the label or if the victim experiences symptoms of harmful effects. Bring the chemical label for reference.</li></ol>
<b>Poisoning by Ingestion or Inhalation</b>	<p>In case of poisoning from ingestion or inhalation: If the victim has collapsed or is not breathing, <b>call 911</b>. Otherwise:</p> <ol style="list-style-type: none"><li>1. If you are the victim, immediately seek assistance from nearby personnel, because you may become incapacitated.</li><li>2. Immediately follow First Aid instructions on chemical label.</li><li>3. Call a poison control center for further advice. In the U.S., call 1-800-222-1222. Have the chemical label available for reference.</li></ol>
<b>Chemical Spills</b>	<p>Chemical spills must quickly be contained and properly cleaned up. Refer to the chemical label for any specific clean-up instructions.</p> <p>General procedures include:</p> <ol style="list-style-type: none"><li>1. Control the spill by stopping the source of the spill.</li><li>2. Contain the spill so that it does not spread and get into water sources.</li><li>3. Clean up the spill immediately.</li><li>4. Seek additional advice from:<ul style="list-style-type: none"><li>– <u>Chemical manufacturer</u>: See chemical label for contact information.</li><li>– <u>State pesticide regulatory agency</u>: In the U.S., call the National Pesticide Information Center at 1-800-858-7378 for assistance in contacting your state's agency.</li></ul></li></ol>

# SAFETY

---

## DURING OPERATION

- Read and follow each chemical label's instructions and warnings.
- Avoid inhaling, ingesting, or coming into contact with any chemicals.
- Know applicable licensing and regulatory requirements for the chemical(s) you plan to use.
- Know emergency procedures before handling chemicals. Carefully review the Chemical Safety section. Also see First Aid instructions on the chemical label.
- Wear protective clothing, eye protection, and chemical-resistant gloves when filling, using, and cleaning the sprayer. Wear additional protective gear, such as a face mask or apron, as recommended on the chemical label.
- Exercise extra caution around children and pets. Keep sprayer and spray materials away from them at all times.
- Do not mix or pour chemicals in an enclosed, unventilated area.
- Do not use flammable or corrosive chemicals in the sprayer.
- Flush the sprayer before switching chemicals in order to prevent dangerous chemical interactions.
- Store pesticides in a correctly labeled container, in a secure location.
- Monitor the health of operators frequently exposed to pesticides, as recommended by the chemical label or local/federal regulations.
- Do not allow anyone younger than 16 years of age to operate sprayer.

## BEFORE SPRAYING

- Inspect and prepare sprayer before each use as directed in this manual.
- Do not start sprayer until ready to spray in order to avoid unintentional spray release.
- Wear additional personal protective equipment if you will be spraying overhead. Wear chemical-resistant head and neck protection, full-face mask (or half-face mask with sealed goggles), and consider using a respirator.
- Do not spray when wind speed exceeds 4 mph in order to minimize spray drift.
- Keep sprayer and spray materials away from children and pets. Pesticides can be especially toxic to children and animals.
- Do not allow anyone younger than 16 years of age to operate sprayer since pesticides are especially toxic to children.

# SAFETY

---

## DURING SPRAYING

- Do not overapply. Apply at rate recommended by chemical manufacturer. Excess pesticide can be dangerous to humans and animals, damage plants, and contaminate soil and water sources.
- Do not eat, drink, smoke, rub your eyes, or touch your bare skin while handling chemicals or spraying.
- Never point the spray wand at people or animals.
- Always hold the spray wand firmly when using it to spray at higher pressures in order to prevent wand from whipping. Keep good footing and balance at all times.
- Do not spray near open flames or sources of heat.
- Exercise extra caution when spraying near areas accessible to children and/or pets.
- Clean up spills immediately per instructions on the chemical label.
- See Troubleshooting section of this manual before attempting any repairs. Wear personal protective equipment and follow safety instructions.

## AFTER SPRAYING

- Clean sprayer immediately after use according to the directions provided in this manual.
- Decontaminate yourself after you are done spraying and have cleaned the sprayer. Wash all exposed areas of the body with soap and water, and remove and launder clothing.
- Dispose of or store remaining chemicals in secure storage with correctly-marked container.



# OPERATING INSTRUCTIONS

## ASSEMBLY

This unit comes fully assembled.

**IMPORTANT: Do not modify sprayer design.**

## BATTERY CHARGING

### ⚠ CAUTION

Never leave the charger connected to the battery for more than 20 hours, as this may damage the battery.

It is recommended to charge the battery for 8–10 hours before using, or if the battery has been stored for six or more months without usage. Once fully charged, the battery should be able to power the sprayer for 40 gallons of fluid, or spray eight consecutive tankfuls.

### To charge the battery:

1. Plug the supplied lithium ion battery charger into a 110V AC electrical receptacle.
2. Insert the plug on the opposite end of the charger into the charging jack located on the back panel of the sprayer.
3. Unplug the charger from the unit and AC receptacle when charging is complete.

## SPRAYER OPERATION

### ⚠ WARNING

Never operate equipment when under the influence of alcohol, drugs, or medication that might alter your judgment and/or reaction time.

### ⚠ CAUTION



Read and adhere to manufacturer's material package labeling, including Safety Data Sheet requirements.

### ⚠ CAUTION

Always use appropriate personal protective equipment, including gloves and safety goggles, when filling sprayer.

### ⚠ CAUTION

When using spray wand, never point it at objects (i.e., humans, vehicles, etc.). Keep at least 10 feet away from objects while using the spray nozzle.

This sprayer is designed to be pulled or pushed by hand.

Pour solution into the tank and stir to mix. For liquid chemicals it is possible to mix by spraying the spray wand into the tank.

Turn the switch to the "ON" position and spray by squeezing the lever on the spray wand. The unit is supplied with a 1.0 gal/min demand pump that will only operate while the lever on the spray wand is depressed.

## Operation Precautions

- Do not operate the pump in an explosive environment. Arcing from the motor brushes or switch or excessive heat from an improperly cycled motor may cause an explosion.
- Do not pump gasoline or other flammable liquids.
- Do not assume fluid compatibility. If the fluid is improperly matched to the pump's elastomers, a leak may occur.

### AFTER SPRAYING CLEAN-OUT

#### **⚠ WARNING**

Some chemicals will damage the pump valves if allowed to soak untreated for a long period of time. Always flush the pump with water after use. Do not allow chemicals to sit in pump for extended times of idleness. Follow chemical manufacturer's instructions on disposal of all waste water from the sprayer.

#### **⚠ CAUTION**

Always use appropriate personal protective equipment, including gloves and safety goggles, when filling or emptying sprayer.

Read and follow each chemical label's instructions and warnings.

Wear protective clothing, eye protection, and chemical-resistant gloves when filling, using, and cleaning sprayer. Wear additional protective gear, such as face mask or apron, as recommended on the chemical label.

After every use, fill the sprayer part way with water. Start the sprayer and allow clear water to be pumped through the plumbing system and out through the spray wand.

Refill the tank about half full with plain water and use a chemical neutralizer such as Nutra-Sol® tank cleaning solution or equivalent, and repeat cleaning instructions. Flush the entire sprayer with the neutralizing agent. Follow the chemical manufacturer's disposal instructions of all wash or rinsing water.

#### **⚠ WARNING**

Do not operate a machine in need of maintenance.

### Periodic Maintenance

- Inspect sprayer broken or worn parts.
- Inspect tubing, hose, and wiring.

### Fuse Replacement

The sprayer contains a 5A fuse next to the power switch. If a problem should occur and fuse replacement is necessary, the replacement fuse must also have a 5A rating. Installing a fuse with a higher rating can damage the system and could start a fire.

### WINTER STORAGE

Proper care and maintenance will prolong the life of the sprayer.

- Drain all water and chemical out of the sprayer and clean as described in the "After Use" section of this manual, paying special attention to pump and valves. These items are especially prone to damage from chemicals and freezing weather.
- The sprayer should be winterized before storage by pumping a solution of RV antifreeze through the entire plumbing.

# TROUBLESHOOTING

## TROUBLESHOOTING

### **⚠ WARNING**

Do not operate a machine in need of maintenance.

### **⚠ WARNING**

Read all warning instructions and safety messages before servicing the sprayer.

### **⚠ WARNING**

Always wear safety glasses with side shields when servicing sprayer system. Failure to do this could result in serious injury to the eyes.

### If the pump will not run:

- Check the fuse next to the power switch. If the fuse is blown or damaged, replace it with a new 5A fuse.
- Ensure that the battery is fully charged.
- Check that the ON/OFF switch is in the "ON" position.
- Ensure that the strainer located on bottom of tank is free of debris.

Whenever service is necessary, your local TurfEx® dealer knows your sprayer system best. Take your sprayer system to your local dealer for any maintenance or service needs on your unit.

### Important Pump Warranty Return Safety Instructions

When you return your pump for warranty or repair, you must always do the following:

- Flush chemical residue from the pump (best done in the field).
- Attach a tag to the pump identifying the type of chemicals sprayed with that pump.
- Include complete description of the operation problem, such as how pump was used, symptoms of malfunction, etc.

Since pumps can contain residues of toxic chemicals, these steps are necessary to protect all the people who handle return shipments and to help pinpoint the reason for the breakdown.

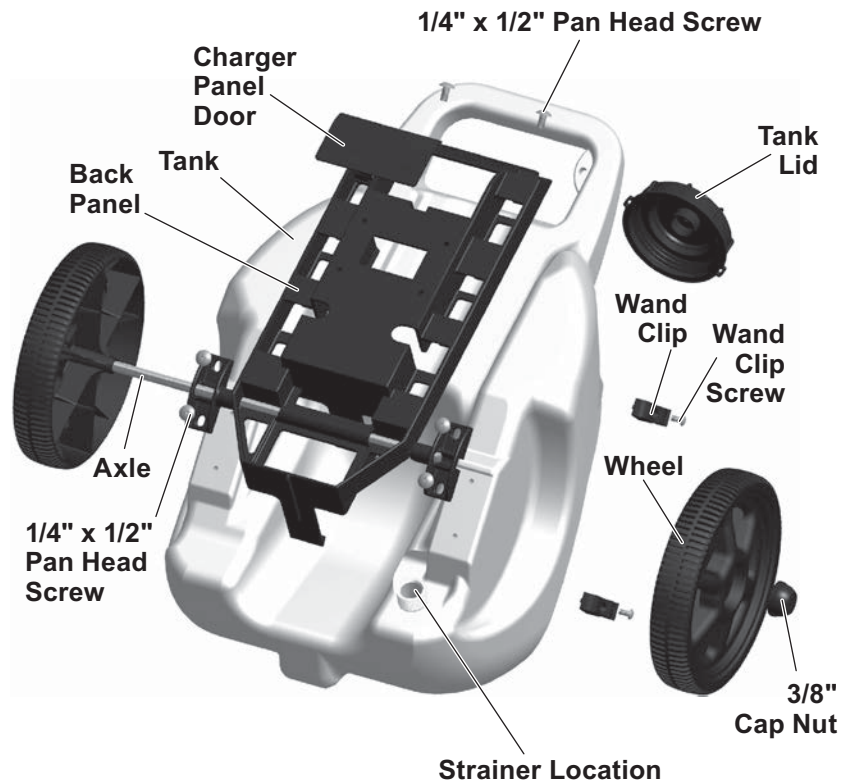



TrynEx International, LLC  
531 Ajax Drive  
Madison Heights, MI 48071-2429  
[www.turfexproducts.com](http://www.turfexproducts.com)

 A DIVISION OF DOUGLAS DYNAMICS, LLC

Copyright © 2019 Douglas Dynamics, LLC. All rights reserved. This material may not be reproduced or copied, in whole or in part, in any printed, mechanical, electronic, film, or other distribution and storage media, without the written consent of TrynEx International, LLC. Authorization to photocopy items for internal or personal use by TrynEx International outlets or equipment owner is granted.

TrynEx International reserves the right under its product improvement policy to change construction or design details and furnish equipment when so altered without reference to illustrations or specifications used. TrynEx International may require or recommend optional equipment for sprayers. TrynEx International offers a limited warranty for all equipment and accessories. Warranty information available at [www.TurfExproducts.com](http://www.TurfExproducts.com). The following are registered (®) or unregistered (™) trademarks of Douglas Dynamics, LLC: TurfEx®.

**Printed in U.S.A.**